

800E PRO LANDING SKID ASSEMBLY ILLUSTRATION

800E PRO 腳架組裝示意圖

ALIGN

Primary hole position designed for T-REX 700E/700E DFC/800E PRO DFC

原孔位適用於：T-REX 700E/700E DFC/800E PRO DFC



M3 Washer

M3華司(φ3xφ8x1mm) x 4



M3 Set screw

M3止咬螺絲(M3x4mm) x 4



Socket screw

圓頭內六角螺絲(M3x10mm) x 4

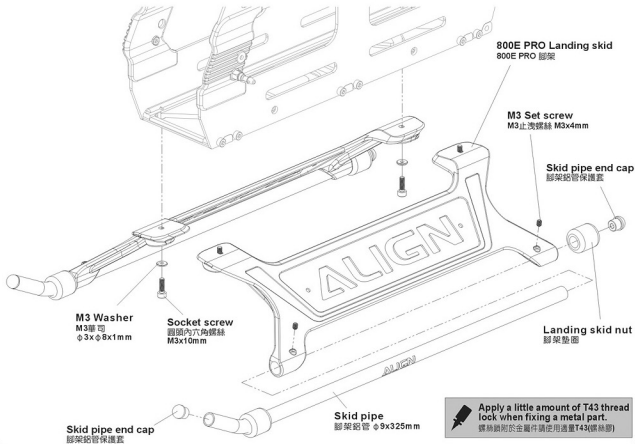

Apply a little amount of T43 thread lock when fixing a metal part.
螺絲鎖附於金屬件時使用適量T43(鎖絲膠)

The drilling hole position suitable for T-REX 700N/800E TREKKER

鑽孔孔位適用於：T-REX 700N/800E TREKKER

For T-REX 700N/800E TREKKER models, please refer to below illustration, accordingly drill the hole by using φ3mm drill tool.

T-REX 700N/800E TREKKER 機型，請參考下圖指示之位置，使用φ3鑽孔工具來進行鑽孔。

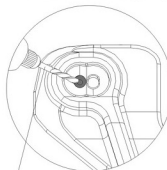

Drill
鑽頭 φ3mm

Drilling locations are here
鑽孔位置



ADDITIONAL TOOLS
REQUIRED FOR ASSEMBLY
自備工具

Drill

鑽頭 φ3mm x1

